

Maintenance Instruction Changing D-Valve

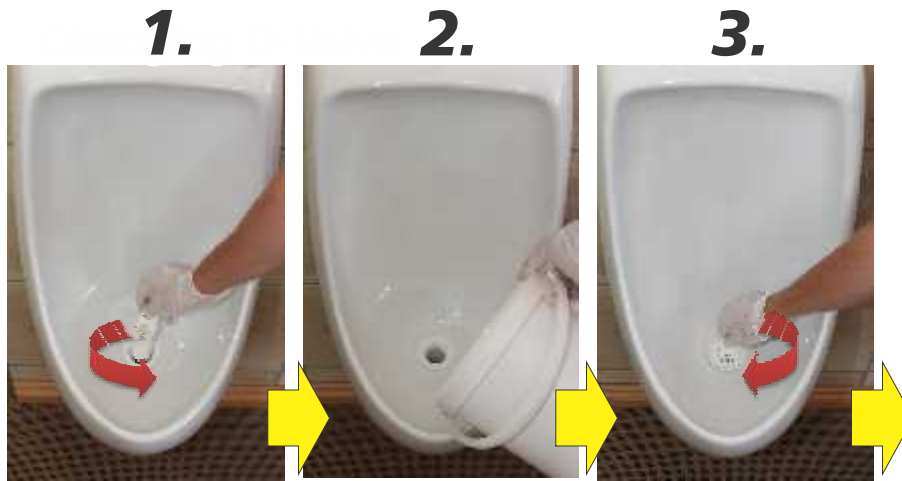

1.
Remove D-Valve with Service Key counter clockwise and dispose

2.
Flush the drain with approximately 10L of water

3.
Install the the new D-Valve clockwise using the Service Key

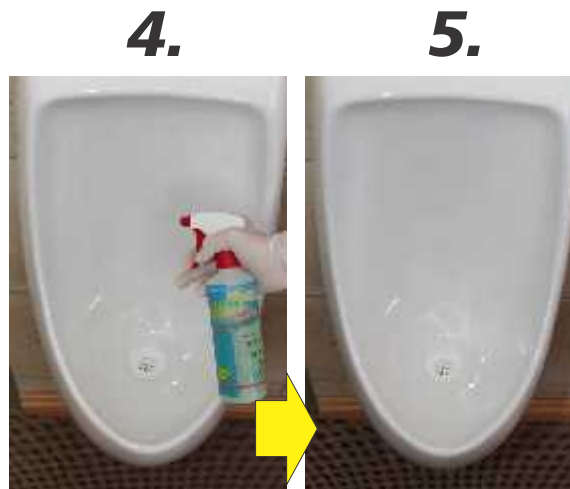

4.
Spray urinal with Biox cleaner.

5.
Finished!

In order to get the best from your waterless urinal it is important that you follow the maintenance instruction above. The D-Valve needs to be changed on average between 2 and 4 times a year depending on usage.